



TBT PILE

SECURING YOUR FOUNDATIONS



Precast Reinforced Concrete Piles



Introduction

TBT Pile products are high strength (C40/50) continuously reinforced precast concrete square piles manufactured under factory controlled conditions by TBT Sdn. Bhd. since 2004, which are suitable for installation in infrastructure and building foundations using impact or injection (Jack-in) machinery.

Quality Assured

All TBT Pile products are produced using duly compliant constituent materials and processes in compliance with an ISO 9001:2015 certified Quality Management System, to ensure high quality and reliability.

Product Design

Standard TBT Pile segments are designed and manufactured in compliance with BS EN 12794:2005 Foundation piles, and the relevant parts of BS EN 13369:2004 – Common rules for precast products

Concrete mix design conforms to BS EN 206:2013 - Concrete, and the relevant complimentary aspects of BS 8500-2:2015, and satisfy the requirements for exposure class XC2.

The standard TBT Pile joint design conforms to joint Class D in BS EN 12794:2015, with splicing of pile segments conducted by partial penetration butt welding.

All TBT Pile products are specifically designed to withstand the normal loads and stresses induced by lifting, transporting, stock-piling, handling, pitching and driving.

Supply to Site

All TBT Pile products are manufactured in rigid steel forms, and are provided with lifting loops for ease of lifting, transporting and stock piling. Ground conditions for the stacking of piles should be firm, and suitable supports should be provided close to the designated lifting points both below and between layers of piles. Pitching of the piles should be performed using slings wrapped around the pile at the designated lifting point.

TBT Pile products may generally be installed 14 days from date of casting.

Welding of joints should be undertaken by suitably experienced personnel using appropriate equipment and welding materials.

Technical Details and Specifications

Standard Pile Elevation

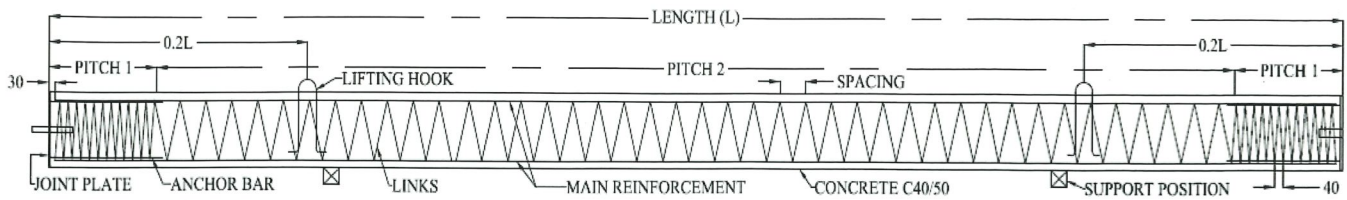

Standard Pile Section

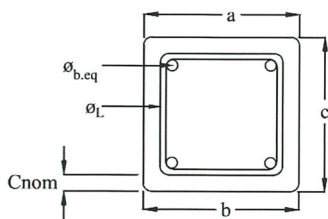

Standard TBT Pile products consist of both extension and initial pile segments with cast-in end caps and / or pile shoes as appropriate.

The recommended axial load capacities detailed below are derived from the structural capacity of standard TBT Pile under virtually concentric loading conditions.

Actual requirements for pile-soil bearing capacities should take geotechnical factors, overall pile slenderness ratios and eccentric forces into consideration.

Standard Specifications

PILE SIZE (mm x mm)	MAIN BARS				LINKS ϕ_L (mm)	PITCH 1 Length (mm)	PITCH 2 Spacing (mm)	JOINT PLATE Thickness (mm)
	No.	ϕ (mm)	$\phi_{b.eq}$ (mm)	%				
125 x 125	4	8	8	1.3	4.0	500	75	4.5
150 x 150	4	8	8	0.9	4.0	500	90	4.5
200 x 200	4	10	10	0.8	4.0	600	100	6
230 x 230	4	12	12	0.9	4.2	750	105	6
250 x 250	12	8	13.9	1.0	4.5	750	105	8
300 x 300	16	8	16	0.9	5.0	900	110	8
350 x 350	4	20	20	1.0	5.5	1200	115	9
400 x 400	4	20	20	0.8	5.5	1200	100	12

PILE SIZE (mm x mm)	STANDARD LENGTHS (m)	NOMINAL WEIGHT (Kg/Ln.m)	COMPRESSION LOAD (MT)	TENSION LOAD (MT)	CRACKING MOMENT (0.2mm) (kNm)
125 x 125	3, 6	38.3	20	4	2.66
150 x 150	3, 6	55.1	25	5	3.25
200 x 200	3, 6	98.0	45	9	7.63
230 x 230	6, 9	129.6	60	13	11.12
250 x 250	6, 9	153.1	75	15	12.68
300 x 300	6, 9	220.5	105	20	18.29
350 x 350	6, 9	300.1	145	32	36.74
400 x 400	6, 9	392.0	200	38	33.47

Company policy dictates the continuous review and improvement of TBT Pile products. All information in this brochure is therefore subject to change without prior notice.



TBT SDN BHD



HEAD OFFICE

TBT Sdn. Bhd.
Lot 43 & 44 Simpang 557,
Kampung Salar Industrial Estate
Jalan Muara, BU1429
Brunei Darussalam

CONTACT

Tel : +673 279 3993
Fax : +673 279 3998
Email : info@tbtbrunei.com

SABAH OFFICE

TBT Piling (Sabah) Sdn. Bhd.
Lot 45 (No.11), Lorong Gunung Ulu Merak 2
Taman Hilltop, Jalan Lintas, Luyang,
88300, Kota Kinabalu, Sabah

CONTACT

Tel : +60 88-213 876
Fax : +60 88-204 687
Email : tbtpilingsabah@gmail.com